

Wall Tie Tester Kit - Mk2

OPERATING INSTRUCTIONS 1/2



TESTING PROCEDURE (external wall tie)

Place the external wall tie adaptor on the end of the wall tie and tighten the grub screws to fix it on tightly (fig 1).

Adjusting the length of the legs on the loading bridge and the position of the tester adaptor head, slot the external wall tie adaptor into the pulling jaw of the tester (fig 2).

Level the load spreading bridge with the adjustable legs and swivel feet before commencing the application of the load. Ensure that the test meter is axially aligned with the wall tie under test (fig 3).

Position the test meter so that the gauge is in the most convenient place to read it. Set the red pointer at zero. Turn the loading handle clockwise to increase the load on the wall tie.

Wind up to an initial load (eg 1kN) and then retighten the grub screws to prevent slippage.

Increase the load until the required test load is attained. Hold this load and observe any falling back of the readings which would indicate movement and possible failure of the fastener. Record the satisfactory result.

To release the load rotate the handle anti-clockwise and push down until the original position is resumed. Lift the test meter off the wall tie adaptor and then unscrew the Wall tie adaptor from the wall.

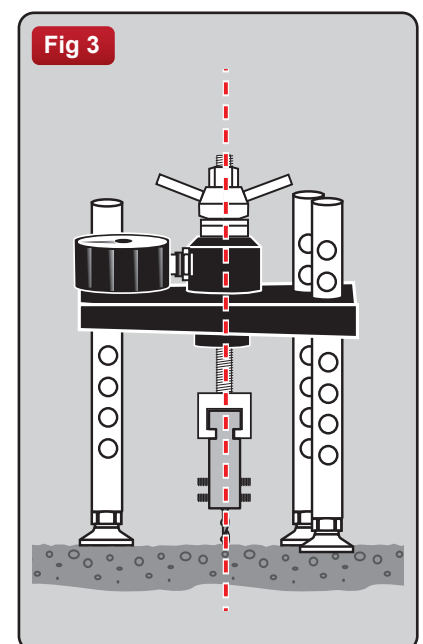
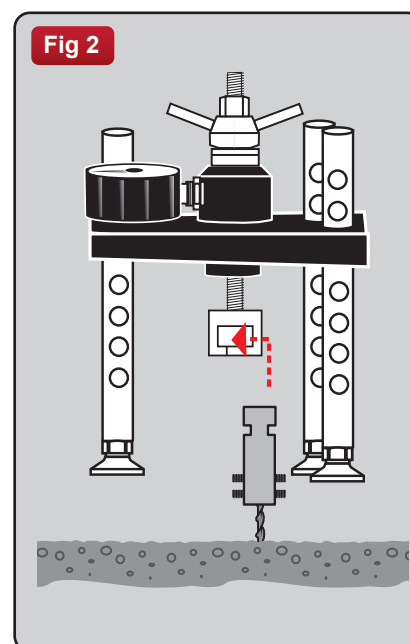
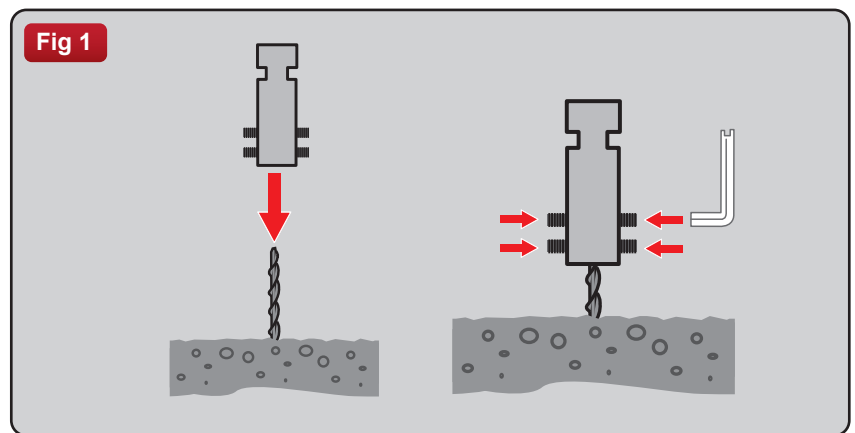

TESTING PROCEDURE (inset wall tie)

Connect the inset wall tie adaptor to the end of the wall tie (**fig 4**).

Adjusting the length of the legs on the loading bridge and the position of the tester adaptor head, slot the inset wall tie adaptor into the pulling jaw of the tester. Level the load spreading bridge with the adjustable legs and swivel feet before commencing the application of the load. Ensure that the test meter is axially aligned with the wall tie under test.

Position the test meter so that the gauge is in the most convenient place to read it. Set the red pointer at zero. Turn the loading handle clockwise to increase the load on the anchor.

Increase the load until the required test load is attained. Hold this load and observe any falling back of the readings which would indicate movement and possible failure of the fastener. Record the satisfactory result.

To release the load rotate the handle anti-clockwise and push down until the original position is resumed. Lift the test meter off the wall tie adaptor and then unscrew the Wall tie adaptor from the wall.

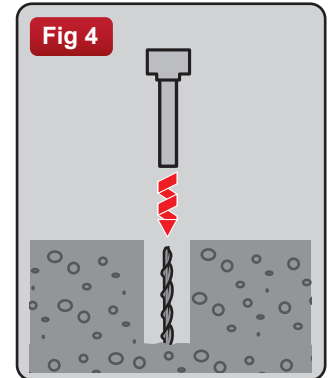

Using the integrated nut

The integrated nut can be used with a 22mm ratchet spanner for better access in confined spaces and for easier operation (**fig 5**).

Remove the handles by unscrewing from the base using the 10mm wrench (**fig 6**). Ensure when re-attaching handles that they are tight on and secure.

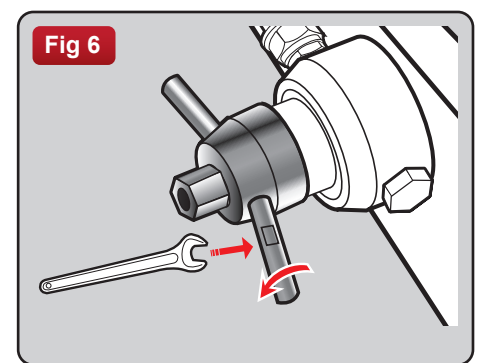
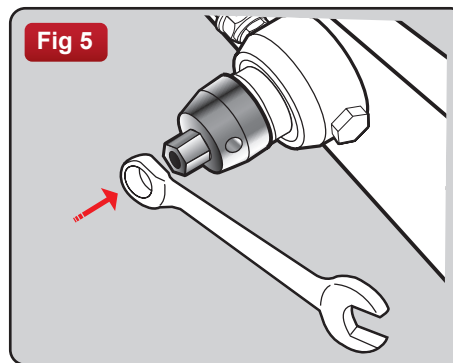

KIT CONTENTS

The Hydrajaws Wall Tie Tester Kit Mk2 comes with:

M5 and M6 threaded rod adaptors;

and External wall tie adaptors - 4.5-8mm and 8-12mm

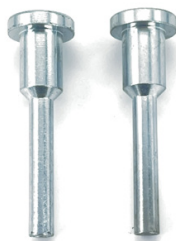

Tester with Gauge 10kN
 Small bolt test adaptor
 M5 threaded rod adaptor
 M6 threaded rod adaptor
 4.5–8mm external wall tie adaptor
 8–12mm external wall tie adaptor
 22mm Ratchet spanner
 10mm spanner
 Piston key
 Oil bottle
 2mm & 3mm Hex key
 Calibration Certificate
 Carry Case with Filler



Optional adaptors (above):
 Inset wall tie adaptors -
 6mm, 8mm & 10mm